

Versatile mounting options:

- Install on post or side wall
- Left-or-right gate opening
- Top or bottom of gate
- Internally or externally
- Push or pull side of gate
- Retrofit with existing hinges

CODE	PRODUCT NAME	FINISH	MAX GATE WEIGHT	MAX GATE WIDTH	MAX OPENING ANGLE
DC622G-L-1-9004	Vertical Gate Closer Left Hand*	Matte Black	150kg	1300mm	130° *Hinges used may limit max opening angle
DC622G-R-1-9004	Vertical Gate Closer Right Hand*				
DCAC632-9004	Mounting Plate for Guide rail	Required to mount to fence pickets			
DCAC633-9004	Mounting Bracket Kit for Body	Use when installing the closer on push side posts and on pull side walls			
Optional hold open device and damper device included in DC622G kits					
GATE GAP: The SlimLine will accommodate any gate gap that results from commonly used hinges					

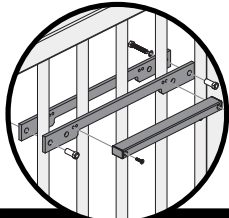

Mounting Plate for Guide Rail
DCAC632-9004

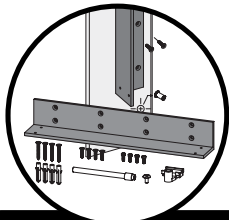

Mounting Bracket Kit for Body
DCAC633-9004

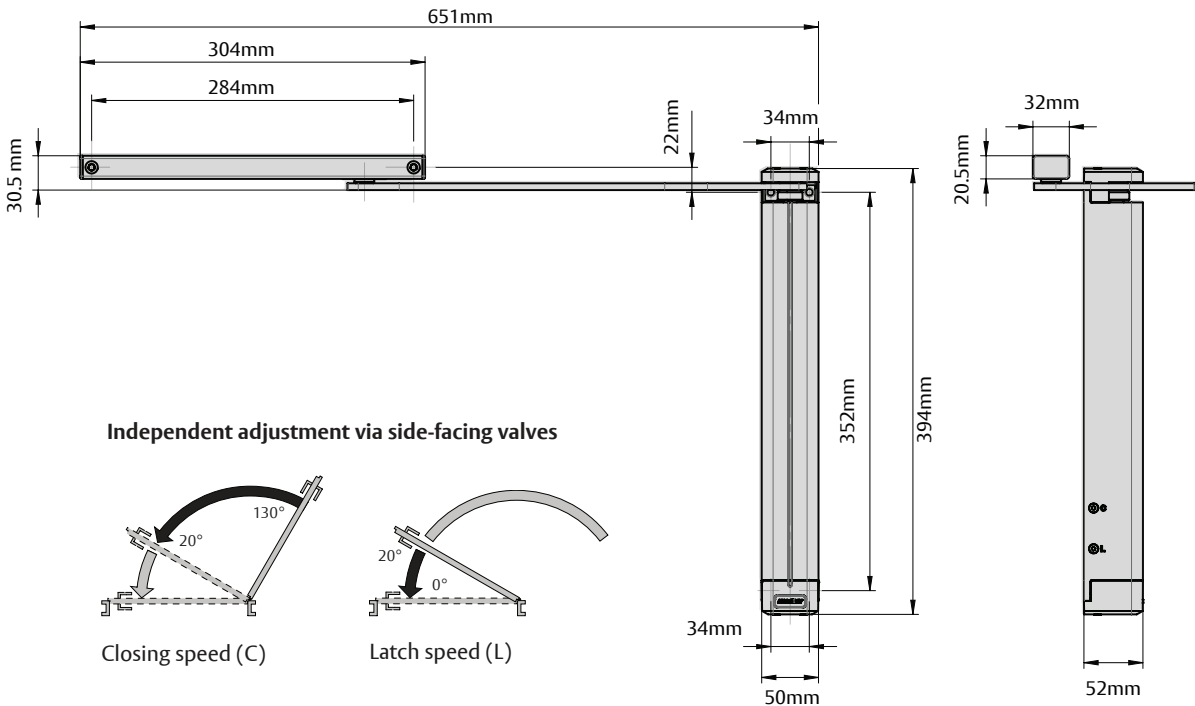
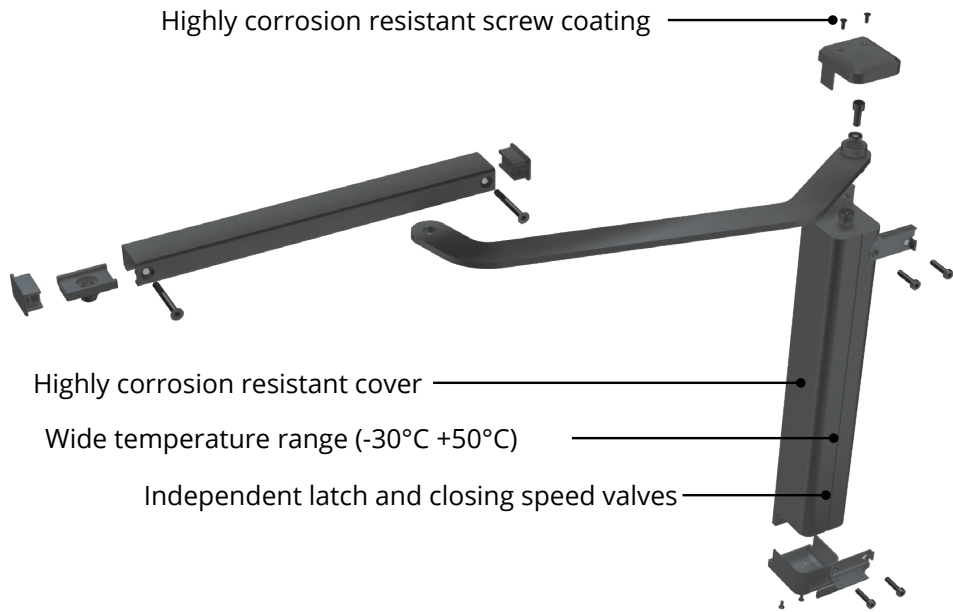

www.ddtech.com

Unit 6, 4-6 Aquatic Drive, Frenchs Forest NSW 2086
Tel: (02) 9454 7888.
Email: sales.ddtech.au@assaabloy.com



D&D Technologies
World's most trusted gate hardware
Part of ASSA ABLOY

Hydraulic Gate Closer

Installs easily, Closes smoothly

SlimLine offers a minimalist, invisible design when mounted vertically behind the gate – perfect for safety and pedestrian gates.

SELF CLOSES GATES UP TO 150kg

Upgrade your self-closing gate installations

- **Accessible for All:** 3D Cam-Motion* Technology enables smooth, secure gate operation – ideal for children, the elderly, and people with disabilities on gates 850mm or wider.
- **Maximum Versatility:** 14 mounting options for gate, post, wall, or rail – vertically or horizontally. Ideal for retrofits with face or centre mounted hinges.
- **Built for Tough Jobs:** Engineered for gates up to 150 kg and 1300 mm wide, with independent latch and closing speed adjustments.
- **Fast, No-Weld Installation:** Complete kit includes fasteners, guide rail, hold-open, and damper for quick, hassle-free setup.
- **All-Weather Reliability:** Durable in harsh conditions, -30°C to +50°C with corrosion-resistant screws and covers.

*The force of 3D Cam-Motion technology ensures gates are light to open but strong enough to close



Suitable for
ADA Use



Self-Closing
Action



No Greasing
Required

Feel the difference with Cam-Motion® Technology

Every user, young or old, can open the gate effortlessly and safely

The DC622G Gate Closer, powered by 3D Cam-Motion® Technology, brings high-end performance to pedestrian and security gates. The DC622G requires less effort to open the gate, ensuring comfortable operation and barrier-free access for all. The closer shuts the gate tight without force. Unlike traditional gate-closing technology, 3D Cam-Motion® does the heavy lifting, so your customers don't have to.

The DC622G with Cam-Motion® delivers smoother gate operation than traditional rack-and-pinion closers. No hard pushing or pulling — just easy, natural movement that's elbow-friendly and ideal for kids, seniors, and anyone with limited mobility.

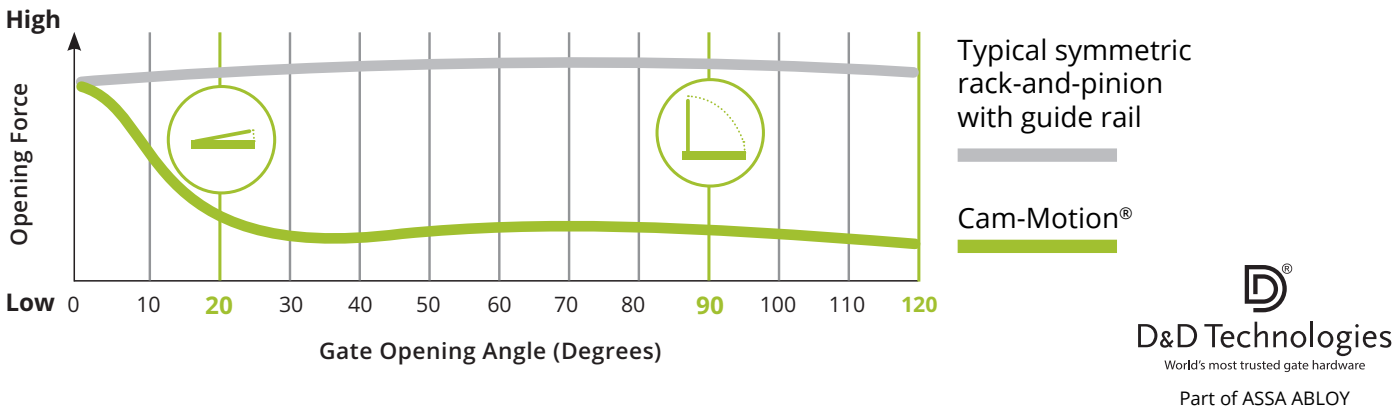

14 Versatile Mounting Options

Mounting Plate for Guide Rail (DCA632-9004) must be installed when closer is mounted on fence pickets.

Post - Pull side

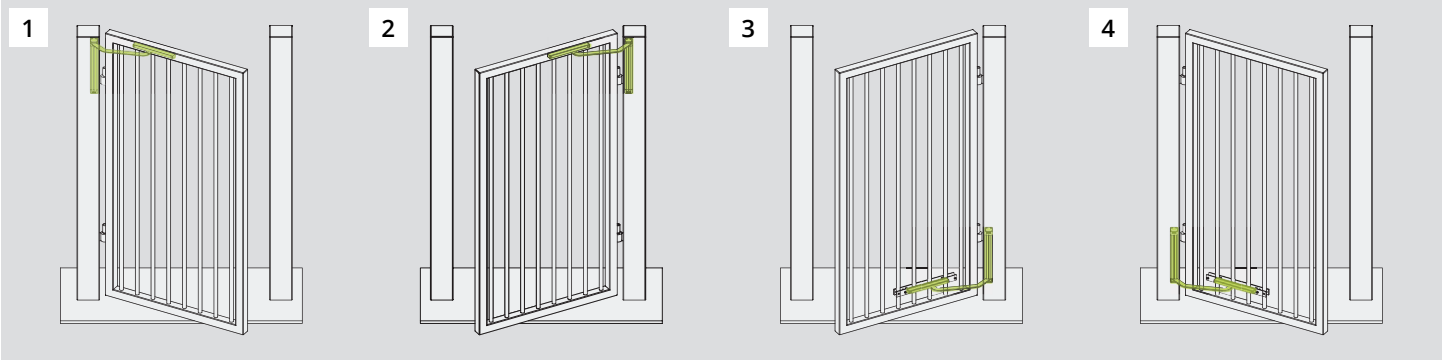

Product Code	DC622G-L-9004	DC622G-R-9004	DC622G-L-9004 DCAC632-9004	DC622G-R-9004 DCAC632-9004
--------------	---------------	---------------	-------------------------------	-------------------------------

Post - Push side

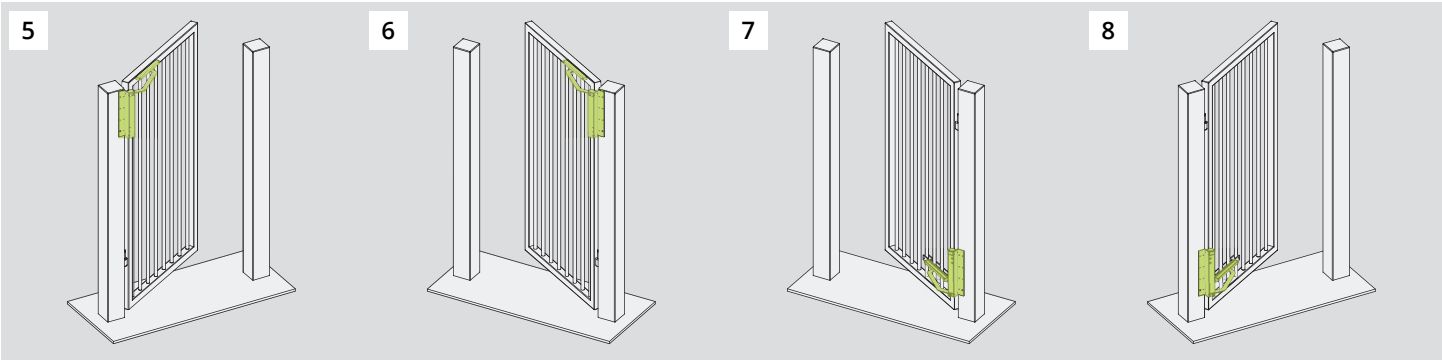

Product Code	DC622G-R-9004 DCAC633-9004	DC622G-L-9004 DCAC633-9004	DC622G-R-9004 DCAC632-9004	DC622G-L-9004 DCAC632-9004
--------------	-------------------------------	-------------------------------	-------------------------------	-------------------------------

Wall - Push side

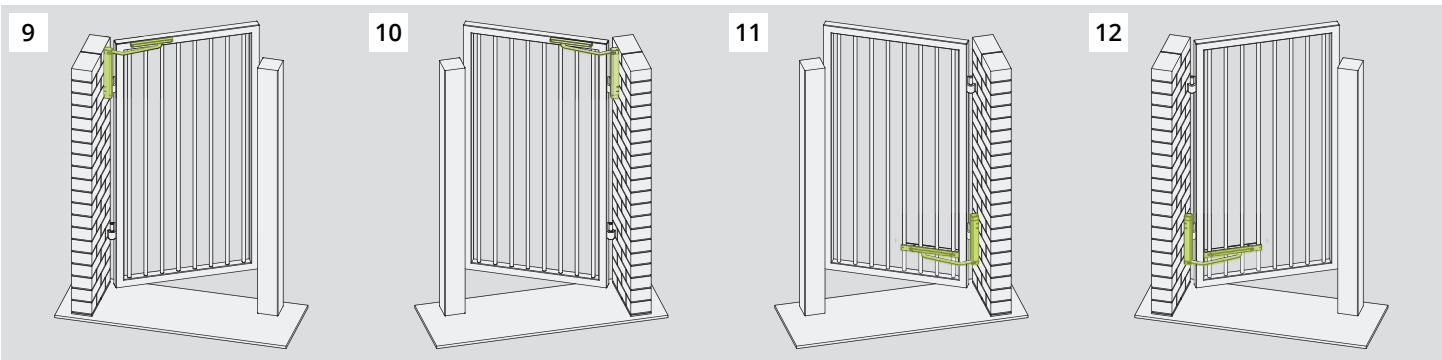

Product Code	DC622G-R-9004	DC622G-L-9004	DC622G-R-9004 DCAC632-9004	DC622G-L-9004 DCAC632-9004
--------------	---------------	---------------	-------------------------------	-------------------------------

Wall - Pull side

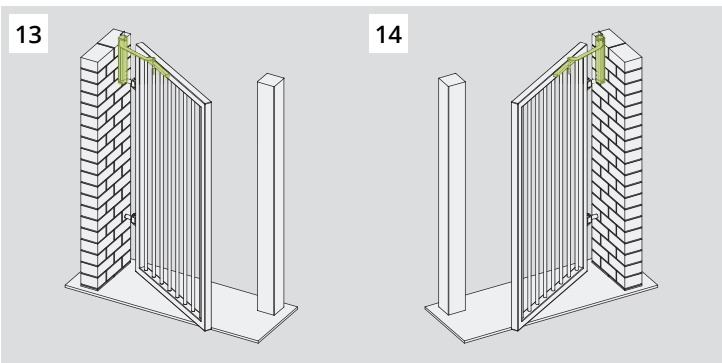

Product Code	DC622G-L-9004 DCAC633-9004	DC622G-R-9004 DCAC633-9004
--------------	-------------------------------	-------------------------------

