



# NEWSLETTER

*This Month*

Lockwood Exidor Series Exit Device

The Ultimate Electronic Padlock by SALTO

Advanced Diagnostics All Keys Lost Solution

# ABUS COMBINATION PADLOCKS



LSC stock the most comprehensive range of ABUS Combination padlocks in Australia. If you're after a school locker padlock, travel combination padlock, colourful aluminium body, quality brass body or something heavier duty, ABUS have a padlock to suit everyone's need. Great for securing, lockers, gates, suitcases, toolboxes & cupboards. With over 60 products to choose from, it's no wonder more security professionals are choosing ABUS combination padlocks

**NEW**

**ABUS Combiflex™ Combination Lock with Adjustable Retractable Cable**  
2503120C

**NEW**

**ABUS Weather Resistant Combination Padlock**  
165IB40C

**ABUS TSA Combination Locking**  
147TSA30C



**ABUS 155 Series**  
Combination Padlock



**ABUS 160 Series**  
Combination Padlock



**ABUS 158 Series & Key**  
Override Combination Padlock



**ABUS 165 Series**  
Combination Padlock



**ABUS 78 Series**  
Combination Padlock



**ABUS 144 Series**  
Combination Padlock



**ABUS 145 Series**  
Combination Padlock



**ABUS Combination**  
Luggage Straps



For more information on the full range of ABUS combination padlocks please visit [lsc.com.au](http://lsc.com.au)



# ECP CAM LOCKS WITH KEY OVERRIDE



*With key override! (KA or KD)*

BORG mechanical digital Cam Lock with ECP (on door code change) with or without key override! Imagine no batteries to worry about & if someone forgets their code, just open with the override key, simple and easy.

- ✓ Easy to install on new or existing cabinets or cupboards
- ✓ Key override options KA or KD
- ✓ Perfect for lockers cabinets, key cabinets & cupboards



**Borg SC Cam Lock ECP**  
 KD BL1706SCECPKD  
 KA BL1706SCECPKA



**Borg MGPRO Cam Lock ECP**  
 KD BL1706MGPROECPKD  
 KA BL1706MGPROECPKA



**Borg Digital Cam Lock ECP**  
 BL1006SCECP



**Borg SC Code Change Cover Plate**  
 BLS101SC



**Borg MGPRO Code Change Cover Plate**  
 BLS101MGPRO

## QUALITY BRAVA EURO STYLE CYLINDERS DOMESTIC & COMMERCIAL

BRAVA has the most comprehensive range of Euro style cylinders for the professional Locksmith market. BRAVA Urban Euro cylinders LW4 & LW5 available in SC, CP, PB & Matt Black.

*All BRAVA Metro & Urban cylinders are easily rekeyable*



locking for life



**BRAVA Euro Single Cylinder with Turn**  
 31705PHBLKCT



**BRAVA Metro Euro Double Cylinder**  
 BRM905551CP



**BRAVA Urban Trilock Cylinder**  
 BRUTRILOCKLW5CP



**BRAVA 90mm Emergency Euro Double Cylinder**  
 31905PHESCKD

# LSC SHOW BUS ON THE ROAD

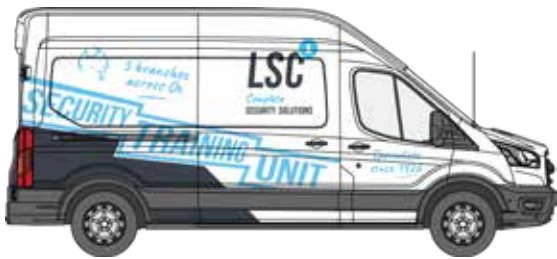

LSC Account Manager, Andrew Larkin, recently hit the road to take STU to visit many of our regional Victorian customers from Warrnambool, Colac, Ballarat, Ararat, Bendigo, Echuca, Cobram, Wangaratta, Albury and Wodonga.

It has also ventured into southern NSW to both Griffith and Wagga Wagga.

Onboard STU customers got hands-on with the Silca Unocode F900, Silca Futura Pro, Futura Auto and the Poker Pro, SMART Pro and the RW5. It's already made a great impression with many of our customers commenting that they would love a work van just like STU!

With 3,900 km's travelled so far STU's journey has only just begun. Next month it will make its way to NSW with trips to Tasmania, Darwin and Katherine already planned.



# PRODUCT SPOTLIGHT

visit [lsc.com.au](http://lsc.com.au) to see BRAVA TE2 cylinder range full range!

## BRAVA URBAN TE2 DOUBLE EURO CYLINDER

Locksmith professionals choose BRAVA TE2 Cylinders for their precision quality & their rekeyable friendly options.

- 5 pin double euro cylinder
- Keyed to differ with 2 keys
- Length 60 mm
- Finished in chrome plate
- Supplied boxed and bar-coded

BRUTE2SDCCP

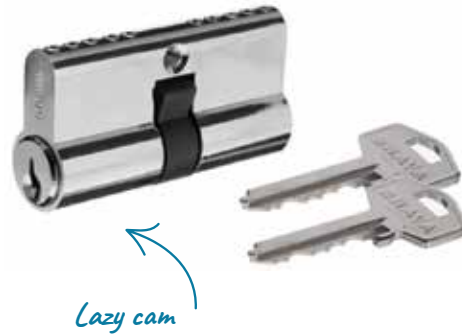

**BRAVA**  
locking for life



## SILCA GTI PRO TRANSPONDERS

- ✓ **Superior Functionality**  
The Silca GTI Pro transponder is tested to hold cloned data for 35 years
- ✓ **Superior Mechanically**  
A GTI Pro transponder, inside a Silca TE key, is proven to continue working perfectly even after being dropped 500 times
- ✓ **10 year Guarantee**  
Only Silca GTI Pro transponders come with a 10 year guarantee



## ADI 802 SERIES LOCKING BARS

ADI locking bars are suitable for use in industrial and commercial buildings, institutions, clubs, schools, hospitals, hotels and similar buildings. High security multi-point locking devices that can be mounted horizontally to any solid core door.

**ADI Bar Locking LB802-1 with Internal Lever / External Cylinder LH**

ADILB8021LH

**ADI Bar Locking LB802-1 with Internal Lever / External Cylinder RH**

ADILB8021RH

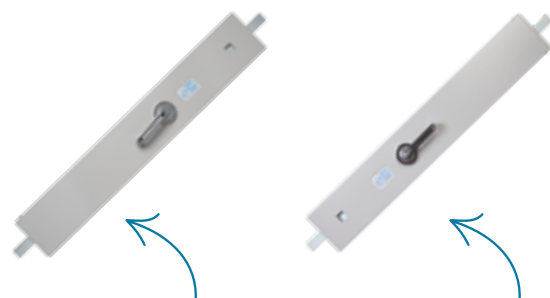

**ADI**  
lockwise



# AD ALL KEYS LOST SOLUTIONS

## ADVANCED DIAGNOSTICS



NEW



**AD SMART Pro Toyota 'H' Bladed All Keys Lost Cable ADC2016**  
New colour coded splitter cable harness for the SMART Pro device  
SD755976AD

- Solution for Toyota 'H' bladed when all keys lost
- Utilised to extract transponder key data from the vehicle
- Connects to specific fuse locations and the key unlock warning switch in the vehicle
- Does not require the removal of the immobiliser ECU from the vehicle
- Works in conjunction with and requires the emulator ADC2015
- Support materials and end user guide available via SMART Pro device, CarLab & MYKEYSPRO



**AD SMART Pro Mercedes All Keys Lost Cable Kit ADC2600**  
New cable kit for the SMART Pro device  
SD756298AD

- Solution for programming keys to select Mercedes when all keys lost
- Removal of and direct connection to Electronic Ignition Switch (EIS) required
- Professionally written and easy to follow end user guide
- Requires and works in conjunction with Mercedes Smart Programmer SD755333ZB
- Security calculation via the dedicated Silca server
- **MERCEDES KEY PROGRAMMING ON SMART PRO DOES NOT USE TOKENS**

## PROMASTER MASTER-KEYING MAINTENANCE

WH Software actively and continually invests in the latest development tools to provide a secure, high performance, efficient and modern user experience.

*Get more than ever!*



Cyber Security should be on your radar as operating systems continue to evolve, and all users of software products are strongly encouraged to keep your, and your customers' data secure via the deployment of the latest updates, patches, versions, and releases.

In addition to providing access to technical support, the latest version updates, newest software features and enhancements, the WH Software Maintenance program lets you:

- Utilise the Pm8 mobile platform
- Enjoy a complimentary installation of ProMaster Key Manager 8
- Receive early notifications of upcoming training courses
- Receive complimentary places on training courses
- Enjoy reseller pricing when purchasing ProMaster8 Key Manager

# MILESIGHT MAKES ITS TECHED DEBUT

NEW

We're excited to launch two new TechED courses:

- Milesight CCTV Fundamentals (Level 1)
- Milesight CCTV Video Management System (Level 2)

Each half-day course is delivered on the same day for your convenience. Choose one or complete both and truly level-up your Milesight knowledge and skills.



## ESC601 MILESIGHT CCTV FUNDAMENTALS | 4.5 HOURS

This course is recommended to installers who want to install network video recorder systems, connect end user apps and provide their customers with a good understanding of how to use the system.

This course will cover topics such as:

- Milesight's camera and NVR product ranges
- CCTV fundamentals including considerations regarding system set up for various lighting, lenses, sensors, resolution and frame rates
- Basic cabling, IP addressing and networks
- Hard drive and bit rate calculations
- Milesight smart tools
- Phone App connection



## ESC602 MILESIGHT CCTV VIDEO MANAGEMENT SYSTEM | 3.5 HOURS

This course is recommended for installers who want to explore the extensive feature set of the Milesight VMS provides for both Milesight and ONVIF cameras.

This course will cover topics such as:

- Milesight VMS (Video Management System)
- Design a VMS CCTV system
- VMS Hardware Considerations and calculations
- Adding and configuring CCTV cameras with VMS
- Reviewing and Exporting footage
- Create Artificial Intelligence events from camera and VMS

*Email [estraining@lsc.com.au](mailto:estraining@lsc.com.au) or register your interest via the TechED tab on our website!*

## INTRODUCING SALTO NEOXX G3

# THE ULTIMATE ELECTRONIC PADLOCK SOLUTION

SALTO Systems has introduced the SALTO Neoxx G3 electronic padlock, the most advanced and versatile locking system on the market, which is suitable for a wide range of access control applications. With exceptional attention to detail, this electronic padlock offers unbeatable durability and reliability, ensuring that property and valuables are kept safe and secure at all times.



### HARDWARE

The SALTO Neoxx G3 padlock is made of hardened steel with a removable shackle model option, ensuring maximum durability. It is also IP66 - IP68 rated for water-resistance and IK08 impact-resistant, making it suitable for any kind of climatic environment, even those that are very extreme. The shackle is available in 8mm diameter and length options of 25mm, 30mm, 60mm, and 90mm. The padlock has been extensively tested, with up to 130,000 operations on a standard set of batteries (4 x LR1).



### CONNECTIVITY

The SALTO Neoxx G3 integrates RFID, Bluetooth LE, and NFC technologies to provide the ultimate keyless experience and the most advanced electronic locking system available. In addition, the Neoxx G3 electronic padlock features SALTO SVN data-on-card and BLUEnet wireless network capable core technologies onboard. The padlock can read, receive, and write information via a smart card or real-time communications over the air (OTA). It is compatible with the SALTO Space, SALTO KS and Homelok platforms.



### CREDENTIALS

The SALTO Neoxx G3 is fully compatible with a wide range of credentials, including card, wristband, fob, or phone (Apple and Android). Users on the SALTO KS system can even use Apple Wallet with an iPhone or Apple Watch.







*The SALTO Neoxx G3 is perfect for a wide range of access control applications and is particularly well-suited for those outdoor deployments that need the reporting and advanced technology that electronic access delivers, as well as a product with a tough exterior that can withstand extreme weather variations. You can extend electronic access to places never before thought possible – outside on the perimeter of property, in remote utility fields, and similar places.*

**Marc Handels, SALTO Systems CTIO.**

**The SALTO Neoxx G3 joins its sister product, the SALTO Neoxx G4.**

*The SALTO Neoxx G3 Padlock is available to order, and LSC can help customers with pre-sales support to system implementation.*



NEW



ASSA ABLOY

## INTRODUCING THE EXIDOR SERIES EXIT DEVICE BY LOCKWOOD

The Lockwood Exidor Series panic hardware offers a modern, aesthetically pleasing style giving optimum safety and security.

- Push bar activated panic exit device
- Available in configurations to suit single and double doors
- Surface mounted
- Shoot bolts and latch options available
- Suitable for doors up to 1220mm wide and 2440mm high
- Tested to 200k cycles
- Non handed



**Exidor Double Door Panic Exit Device Kit with 2 Vertical Devices, Silver**  
EXI284SIL



**Exidor Double Door Panic Exit Device Kit with Horizontal and Vertical Devices, Silver**  
EXI285SIL



**Exidor Vertical Panic Exit Device, Silver 1220 x 2400mm**  
EXI294SIL



**Exidor Horizontal Panic Exit Device, Silver 1220mm**  
EXI296SIL



**Exidor Panic Exit Device Accessory Outside Access Device with Lever and Euro Cylinder Hole Silver**  
EXI325EASIL

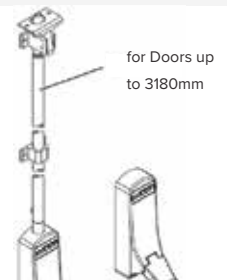

**Exidor Panic Exit Device Accessory Extended Top Shoot Tube for Doors up to 3180mm**  
EXIP0804SIL

# ROSS SAFE LOCK SERIES



**ROSS standard safe lock with cover.** Suitable for floor, wall, drug, night, home and office safes/cabinets. Lock can be removed from the weld-on cover for servicing. Supplied Keyed to differ or keyed alike.

- ROSS 600 Series AL 08952660
- ROSS 600 Series RH 08952640
- ROSS 600 Series AL keyed alike in 2'S 08952673
- ROSS 600 Series AL keyed alike in 3'S 08952677
- ROSS 600 Series AL keyed alike in 4'S 08952678



*visit [lsc.com.au](http://lsc.com.au) to see ROSS safe locks series complete range!*

**Features:**

- 6 pick resistant levers
- 1,000,000 possible combinations
- 2 x steel single bitted keys
- 10 keys sizes available from 30 to 180 mm

**Optional:**

- Steel keyhole inserts 4 sizes available
- Master keying
- Keystop & hardened plates
- Latching bolt

**Versions:**

- Dual control, safe-deposit, motel
- Electronic, time delay
- Narrow style, bolt on

# ADI BLOCKLOKS

The range of ADI Blockloks needs no introduction to locksmiths and security installers alike, as they will already be more than familiar with the quality, strength and ease of installation of this great range of products. Suitable for securing shop fronts, warehouses, hotels, community recreation areas, storage facilities and garages.



**ADI BLOCKLOK 444DD**  
Double, Satin Chrome  
44142040



**ADI BLOCKLOK 444**  
Single, Satin Chrome  
44142030



**ADI BLOCKLOK 444FM**  
Single Front Mount, Satin Chrome  
44142035



**ADI BLOCKLOK 444DDFM**  
Double Front Mount, Satin Chrome  
44142045

# FRESHEN UP YOUR SURVEILLANCE



# Milesight

## SCALABLE VIDEO MANAGEMENT SOFTWARE

Milesight VMS Enterprise is a professional and intelligent video management software for businesses. Compatible with most third party cameras, it can simplify and amplify your video surveillance.

With advanced client/server architecture, it fulfils your demands and expectations, with rich core functions including live view, record, E-Map, on server and edge AI functionality, event alarm and smart analysis.



### Milesight VMS Enterprise 1 Channel Camera Access with Analytics

MC001

### Milesight VMS Enterprise 4 Channel Camera Access with Analytics

MC004

### Milesight VMS Enterprise 1 Channel ANPR Module

ML001

### Milesight VMS Enterprise 1 x Video Wall Module Per Server

MSVIDEOWALL

## MILESIGHT VISIT TO LSC

We were delighted to host Milesight Oceania Sales Manager, Mike Lu, Senior Technical Specialist, Sky Lin and IoT Sales Manager, Ana Lim at our Distribution & Training Centre in Brooklyn in late April.

The trio enjoyed a tour of our modern distribution centre before giving our Victorian sales team a sneak peek at the Milesight product development roadmap.

We were equally pleased to have Mike and Sky join us for the Brisbane and Sydney LEGS of the SecTech Roadshow to launch the new Milesight Enterprise VMS, which was well received by installers and end-users alike.

*Thank you Milesight for a wonderful visit!  
We look forward to continuing to work together in the future.*



# SECTECH ROADSHOW 2023 REVIEW



## SECTECH ROADSHOW

Throughout May, LSC were privileged to take part in the SecTech Roadshow.

SecTech is one of our favourite events on the calendar, and this year was no different. We showcased a fantastic range of electronic security products from Milesight, RISCO, Dahua, CS Technologies, Creone, SALTO & HID.

Visitors were delighted to see the latest and greatest electronic security innovation on display. We were excited to introduce the Milesight VMS to visitors along with our offerings from CCTV to electronic access, key storage and the revolutionary LightSYS+ hybrid alarm from RISCO.

Beginning in Brisbane, we toured on to Sydney, Melbourne, Adelaide, and finished in Perth. We were delighted to reunite and meet with customers, friends and colleagues from across the electronic security industry.

It's fantastic that LSC has become so integral to electronic security installers across the country. Thanks for joining us at SecTech.

## ABOUT SECTECH

SecTech Roadshow is a touring tradeshow that covers 5 Australian state capitals over 2 weeks every year in May and draws 2,000-2,500 attendees.

The compact size and local venues make SecTech Roadshow the perfect opportunity for installers and end users to get face time with leading suppliers and manufacturers and their solutions in a vibrant half-day event.

## PARTNER BRANDS



# MLAA VIC BRANCH WRAP UP

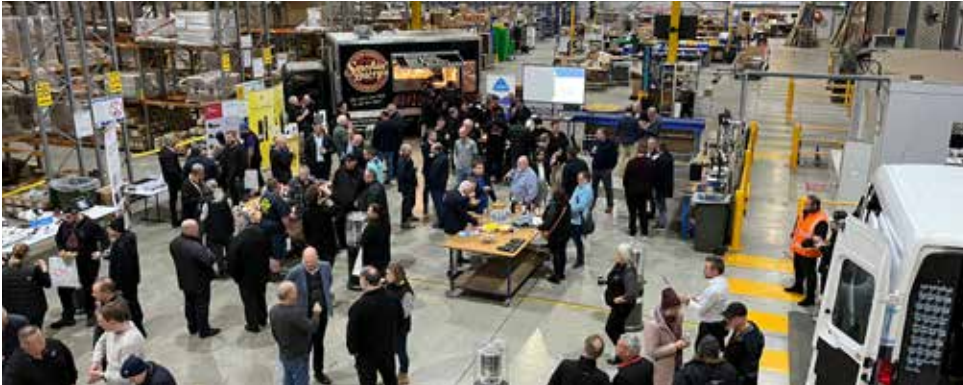

## MLAA VIC BRANCH MEETING

A huge shoutout & heartfelt thanks to all the incredible MLAA members who joined us at our Distribution & Training Centre for the Victorian MLAA Branch Meeting!

We were proud to introduce our new Security Training Unit, STU to so many people at the event. STU has just got back from touring many parts of regional Victoria. We've also got bold plans for the future, aiming to take STU just about everywhere across regional Australia.



Despite it being a chilly Melbourne winters night, Barry's BBQ Bus provided hot food for the masses. Visitors enjoyed watching our staff provide machine demos and we did our best to warm the space with gas heaters throughout.

It was an absolute pleasure having you here, fostering a strong locksmith community in Melbourne. Your presence and contributions made the event a great success. Thanks as well to the Master Locksmiths Association of Australasia for putting on these events.



# HAPPY CUSTOMERS



**METROPOLITAN LOCKSMITHS (WA)**

Andrew Newlan from Metropolitan Lock Service is over the moon with his purchase of the Advanced Diagnostics SMART Pro, the most reliable diagnostic tool on the market.



**LIGHTHOUSE LOCKSMITHS (WA)**

Here is a happy snap of Aaron Blight and Adam Robertson from Lighthouse Locksmiths with their new Silca Unocode F800.



**CONCEPT LOCKSMITHS (QLD)**

Shaun from Concept Locksmiths was all smiles with his purchase of a new Silca Futura Edge.



**JOHN BARNES & CO MELBOURNE (VIC)**

Eddie from John Barnes was very happy to share his feedback about the new Silca F800 they purchased recently - *"It's a dream honestly, currently running a 60 key order while having a coffee and replying to emails."*

*Customer Testimonial*



**LAST CHANCE**

## TEMPORARY FULL EXPENSING TO END JUNE 30TH

Some customers know it as "instant asset write off", but the technically correct term is "Temporary Full Expensing", and it allows eligible businesses to deduct the full cost of eligible depreciating assets, in the year they are first held or first used and installed for a taxable purpose.

For normal people, what that means is you get good financial support to invest in your business. With the pressure on the labour force, smart businesses are investing in equipment and automation to ease the burden – your LSC Account Manager can advise what's right for you. We're not experts\*, but talk to your accountant who can advise if this opportunity will help your financial position.

\* Advice given is general in nature, and may not be applicable, or may not suit your financial situation. Talk to your Financial Services provider for full details.

**ADVANCED  
DIAGNOSTICS**

**AD**  
SMART Pro  
TOKEN  
SPECIAL



# AD SMART PRO SPECIAL 12 MONTH SUBSCRIPTION

## 50% OFF

SD755115AD\*

/// END OF FINANCIAL YEAR DEALS /// END OF FINANCIAL YEAR DEALS /// END OF FINANCIAL YEAR DEALS



AD SMART Pro  
Tokens PK25  
SD748569AD

**5% OFF**



AD SMART Pro  
Token PK50  
SD751863AD

**10% OFF**



AD SMART Pro  
Token PK100  
SD751862AD

**12.5% OFF**

\*Only one purchase per Serial No. Not available to customers currently using UTP with greater than 90 days remaining on the current UTP.



SMART Pro + Activation + 12 Month UTP SMARTPRO1

**\$6647**

SMART Pro + Activation + 1 Month UTP + 25 Token PK SMARTPRO3

**\$5639**

SMART Pro + Activation + 3 Month UTP \*Trade in offer only SMARTPRO4

**\$5632**

\*\*Terms and Conditions: Promotional prices advertised are quoted in AUD and exclude GST. Prices are valid until 30/06/23.

### TERMS & CONDITIONS

Product features and pricing in this newsletter are subject to change without notice. Special promotional prices advertised here are for the month the newsletter has been published. However, some offers may commence on or extend beyond the promotional period. Most products have been photographed in-house and are identical to what you will receive. Information presented in this newsletter has been checked and is believed to be correct at the time of printing, however, errors and omissions may occur. LSC can not guarantee prices, specifications, or features of products that may change after printing.